

Printing and E-Filing Tax Forms

Available in Sage 50 Pro Accounting and Higher
Quick Reference Guide

How do I access my payroll tax forms?

Go to the Employees & Payroll Navigation Center and select Forms. Here you can access both state and federal forms.

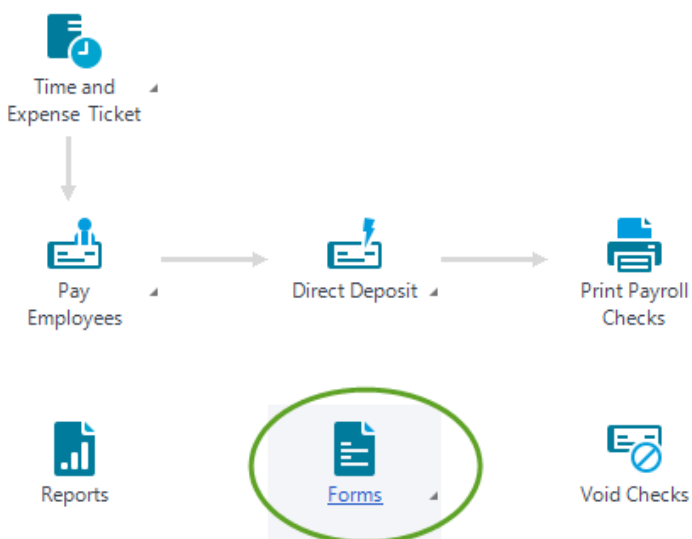

Printing and e-Filing

If you have subscribed and registered a payroll tax solution, you have access to the convenient Print-N-Sign forms (compatible with laser or inkjet printers). You can print or e-File federal and state tax forms on plain paper. You have access to over 260 state and federal forms and will receive updated tax changes throughout the year.

Payroll Tax Form Selector

Select a form

Select form type:

- Federal
- State
- Existing Form

Available Forms:

- Federal Tax Deposit (EFTPS)
- 2019 940 Report
- 2019 940 Puerto Rico Form
- 2019 941/Schedule B/941-V
- 2018 941 Puerto Rico
- 2019 941-SS/Schedule B/94
- 941-X Report
- 2019 943/943-A/943-V Repr

Description:

EFTPS Form 8109. Use this to make 940, 941, 943, 944, and 945 electronic payments.

Buttons: OK, Cancel, Help

Select filing period

Frequency: Yearly

Year: 2022

Select employees for W-2s

Type: All

From: []

To: []

You can create a new form or open a form that was saved. To create a new form, select either Federal or State, select the filing period and click OK. If you are creating W-2s, select the appropriate employees as well. To open a saved form, select Existing Form and click OK to view a list of previously saved forms. The generated forms may look different from the official printed tax forms, but all forms in the list of available forms have been accepted as fully compliant by the appropriate tax agencies.

Select the form, filing period, and employees, and click OK.

Sage 50's Print-N-Sign tax forms allow you to enter information in the proper fields. You can print most forms on plain paper.

Review / Edit My Copy Federal Copy

2 pages **Red Fields must be filled before continuing.** Print Save Prev Step Next Step

Aatrix Rev. 6/18/14 950214

Name (not your trade name) **BELLWETHER GARDEN SUPPLY** Employer identification number (EIN) **58-2560752**

Part 2: Tell us about your deposit schedule and tax liability for this quarter.

If you are unsure about whether you are a monthly schedule depositor or a semiweekly schedule depositor, see Pub. 15 (Circular E), section 11.

14 Check one:

Line 10 on this return is less than \$2,500 or line 10 on the return for the prior quarter was less than \$2,500, and you did not incur a \$100,000 next-day deposit obligation during the current quarter. If line 10 for the prior quarter was less than \$2,500 but line 10 on this return is \$100,000 or more, you must provide a record of your federal tax liability, if you are a monthly schedule depositor, complete the deposit schedule below. If you are a semiweekly schedule depositor, attach Schedule B (Form 941). Go to part 3.

You were a monthly schedule depositor for the entire quarter. Enter your tax liability for each month and total liability for the quarter, then go to Part 3.

Tax liability: Month 1

Month 2

Month 3

Total liability for quarter Total must equal line 10.

You were a semiweekly schedule depositor for any part of this quarter. Complete Schedule B (Form 941), Report of Tax Liability for Semiweekly Schedule Depositors, and attach it to Form 941.

Print the form now or save for later.

If you prefer to electronically file your forms, click the e-File button if you have subscribed to Sage 50's e-Filing service.

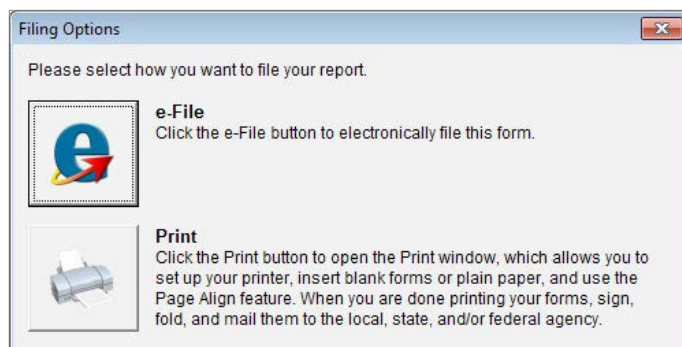

Did you know?

You can [view more information or subscribe to a payroll tax solution online.](#)